

# EDGING SUEDE MILL FINISH ALUMINIUM

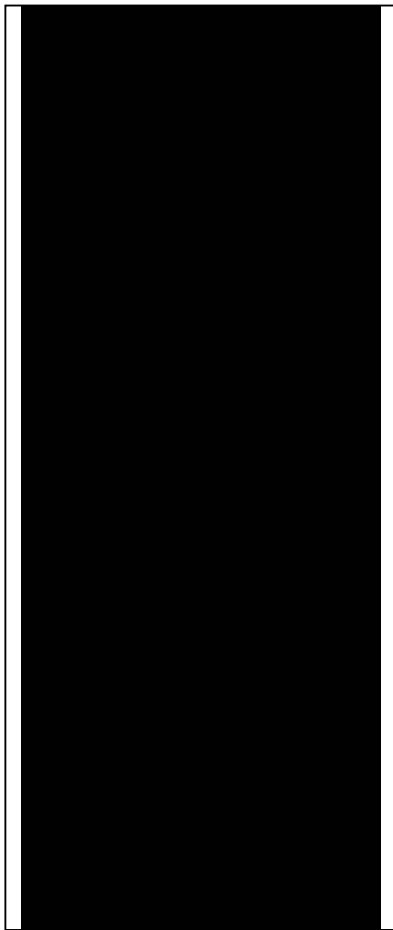

## EDGING

<b>RANGE</b>	Suede
<b>GROUP</b>	Edging Haute Couture Series
<b>MATERIAL</b>	Extruded mill finish aluminium
<b>FINISH</b>	Mill finish
<b>SUBSTRATE</b>	As to particular product/substrate type recommendation
<b>FIXING</b>	As to particular method for product/substrate type recommendation

## FEATURES

Continuous band of resilient slip resistance inserted into engraved cavities for the entire width and length of the section designed and manufactured by DTAC in Australia

Available in two exclusive DTAC Haute Couture sections of flat or angle in extruded hard anodised aluminium

DTAC integrated hooped shafts for special project substrate mountings are also available for all three sections (patents and design registrations applied and granted)

Special substrate mounting are available on request

Suitable for all stable finished surfaces and substrates

Designed to comply with AS/NZS 1428.1 (2009) Design for Access and Mobility Part 1: General Requirements for Access – New Building Work

Designed to comply with the Building Code of Australia and Disability (Access to Premises – Buildings) Standards to meet the deemed-to-satisfy-provisions

Tested for compliance with slip resistance requirements as detailed in HB 197 (1999)

10 year product (mill finish aluminium), 5 year product for colour stability (polymer inlays and inserts), 2 year installation warranty

Extended warranty and essential services maintenance options available on request

DTAC's facility to reclaim, recycle and reinstate

## AVAILABLE SIZES

**CODE** SUEDE-AL-55x3

**FLAT** W55 x T3 mm



**CODE** SUEDE-AL-10x55x3

**ANGLE** H10 x W55 x T3 mm



**CODE** SUEDE-AL-25x55x3

**ANGLE** H25 x W55 x T3 mm

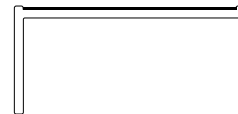

**CODE** SUEDE-AL-50x55x3

**ANGLE** H50 x W55 x T3 mm

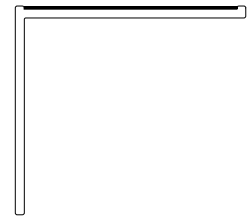

**MELBOURNE  
SYDNEY**

**CANBERRA  
BRISBANE  
ADELAIDE**

**PERTH  
DARWIN  
HOBART**

**DTAC PTY LTD**  
ABN 41 093 070 127

Unit 4, 1-7 Friars Road  
Moorabbin Victoria  
Australia 3189  
PO Box 2210  
Moorabbin Victoria  
Australia 3189

T 1300 793 478  
F 1300 780 628  
estimating@dtac.com.au  
www.dtac.com.au

# EDGING SUEDE MILL FINISH ALUMINIUM



## SLIP RESISTANCE TESTING

Important information about slip resistance ratings: To determine a classification of a slip resistance rating, see Australian Standards Hand Book 197: 1999 (HB 197), An Introductory Guide to Slip Resistance of Pedestrian Materials. This document outlines the minimum ratings of a location and situation of a pedestrian surface.

<b>TEST</b>	<b>AS/NZS 4586:1999 APPENDIX A</b>
<b>TYPE</b>	Wet Pendulum Test
<b>55MM</b>	Tested across a 55mm wide section
<b>RATING 1</b>	Four S Slider = TBA
<b>RATING 2</b>	TRRL Slider = TBA
<b>CLASS</b>	Mean BPN = Class N/A
<b>REPORT</b>	Available on request from DTAC

## LUMINANCE TESTING

Important information: To determine a luminance contrast between a substrate and the DTAC EDGING, see: AS/NZS 1428.1 2009 Page 59-98, appendix B, Parts B1-B4 and Table B1. Please note: Appendix B par B5, (The Measurement of Luminance Contrast – On Site), has not been included in these test results given that the substrate/finished surface that the edging will be installed onto is unknown. On site luminance testing can be conducted by DTAC but will incur additional consultation fees to that of the services offered by DTAC for this product range (DTAC Pty Ltd January 2010).

<b>TEST</b>	<b>AS 1428.1 2009 APPENDIX B PART B3</b>
<b>TYPE</b>	Design for Access and Mobility Part 1: General Requirements for Access – New Building Work
<b>RATING</b>	Luminance Reflectance rating / Dry TBA / Wet TBA
<b>REPORT</b>	Available on request from DTAC

<b>MELBOURNE</b> <b>SYDNEY</b>	<b>CANBERRA</b> <b>BRISBANE</b> <b>ADELAIDE</b>	<b>PERTH</b> <b>DARWIN</b> <b>HOBART</b>
<b>DTAC PTY LTD</b> ABN 41 093 070 127	Unit 4, 1-7 Friars Road Moorabbin Victoria Australia 3189 PO Box 2210 Moorabbin Victoria Australia 3189	T 1300 793 478 F 1300 780 628 estimating@dtac.com.au www.dtac.com.au

# EDGING SUEDE MILL FINISH ALUMINIUM INSTALLATION

**DTAC PTY LTD**  
ABN 41 093 070 127

Unit 4, 1-7 Friars Road  
Moorabbin Victoria  
Australia 3189  
PO Box 2210  
Moorabbin Victoria  
Australia 3189

T 1300 793 478  
F 1300 780 628  
estimating@dtac.com.au  
www.dtac.com.au

## TYPE 1 SUBSTRATES

### STONE, MASONRY, TIMBER, VINYL

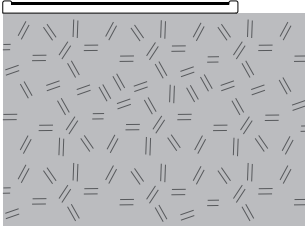

**FIXING** Screw fixed or adhesive

**NOTE** DTAC integrated hooped shafts for substrate mountings are available on request

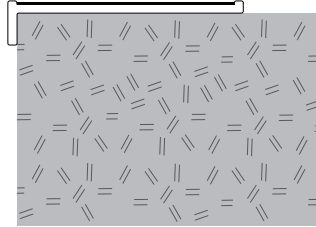

**FIXING** Screw fixed or adhesive

**NOTE** DTAC integrated hooped shafts for substrate mountings are available on request

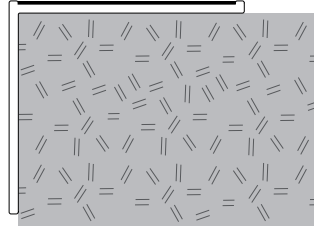

**FIXING** Screw fixed or adhesive

**NOTE** DTAC integrated hooped shafts for substrate mountings are available on request

## TYPE 2 SUBSTRATES

### VITRIFIED PORCELAIN, CERAMICS, GLASS, METALS

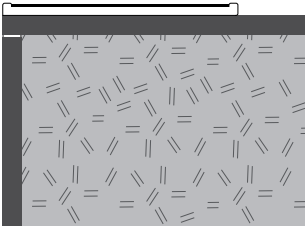

**FIXING** Screw fixed or adhesive

**NOTE** DTAC integrated hooped shafts for substrate mountings are available on request

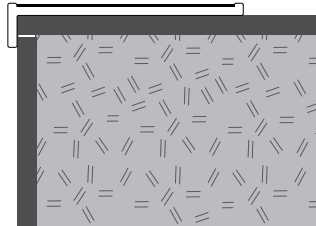

**FIXING** Screw fixed or adhesive

**NOTE** DTAC integrated hooped shafts for substrate mountings are available on request

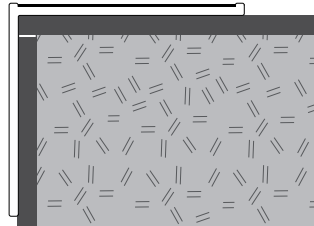

**FIXING** Screw fixed or adhesive

**NOTE** DTAC integrated hooped shafts for substrate mountings are available on request



**FIXING** Screw fixed or adhesive

**NOTE** DTAC integrated hooped shafts for substrate mountings are available on request

## TYPE 3 SUBSTRATES

### CARPET, CARPET TILES

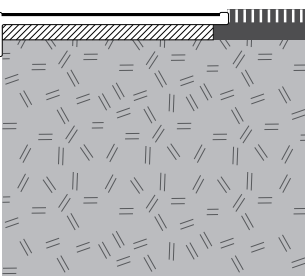

**FIXING** Screw fixed or adhesive

**NOTE** DTAC integrated hooped shafts for substrate mountings are available on request

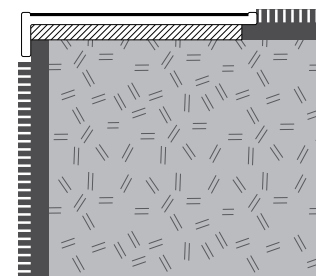

**FIXING** Screw fixed or adhesive

**NOTE** DTAC integrated hooped shafts for substrate mountings are available on request

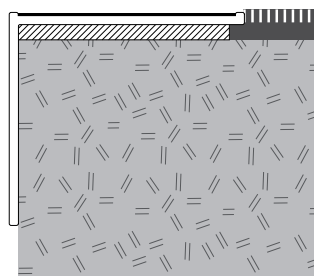

**FIXING** Screw fixed or adhesive

**NOTE** DTAC integrated hooped shafts for substrate mountings are available on request

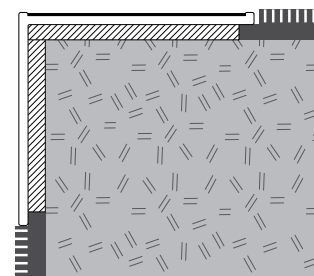

**FIXING** Screw fixed or adhesive

**NOTE** DTAC integrated hooped shafts for substrate mountings are available on request